

# Monbulk College

**Policy:**

**Date Ratified:**

**Date of Last Review**

**Anaphylaxis**

**August 2008**

**May 2016**

## **BASIC BELIEFS:**

- Anaphylaxis is a severe, rapidly progressive allergic reaction that is potentially life threatening. The most common allergens in school aged children are peanuts, eggs, tree nuts, cow's milk, fish and shellfish, wheat, soy, sesame, latex, certain insect stings and medication.
- The key to prevention of anaphylaxis in schools is knowledge of those children who have been diagnosed at risk, awareness of triggers (allergens), and prevention of exposure to these triggers. Partnerships between schools and parents are important in ensuring that certain foods or items are kept away from the student while at school.
- Adrenaline given through EpiPen® autoinjector to the muscle of the outer mid-thigh is the most effective first aid treatment for anaphylaxis.

## **AIMS:**

- To provide , as far as practicable, a safe and supportive environment in which students at risk of anaphylaxis can participate equally in all aspects of the student's schooling including prevention strategies to minimise the risk of an anaphylactic reaction.
- To raise awareness about anaphylaxis and the school's anaphylaxis management policy in the school community
- To engage with parents/carers of students at risk of anaphylaxis in assessing risks, developing risk minimisation strategies and management strategies for the student
- To ensure that each staff member has adequate knowledge about allergies, anaphylaxis and the school's policy and procedures in responding to an anaphylactic reaction.
- The College will comply with the Ministerial Order 706: Anaphylaxis Management in Victorian Schools and guidelines, as indicated below and referenced,

## **IMPLEMENTATION PROCEDURES**

### *INDIVIDUAL ANAPHYLAXIS MANAGEMENT PLANS*

The principal will ensure there is an individual management plan, developed in consultation with the student's parents, for any student who has been diagnosed by a medical practitioner as being at risk of anaphylaxis. The plan should be in place as soon as possible after the student enrolls and where possible before their first day of school. Refer to Anaphylaxis Guidelines for Victorian Government Schools, [DE&T Anaphylaxis Guidelines](#).

The individual anaphylaxis management plan will set out the following:

- Information about the diagnosis, including the type of allergy or allergies the student has (based on a diagnosis from a medical practitioner).
- Strategies to minimise the risk of exposure to allergens while the student is under the care or supervision of school staff, for in-school and out of school settings including camps and excursions.
- The name of the person/s responsible for implementing the strategies.
- Information on where the student's medication will be stored.

- The student's emergency contact details.
- An emergency procedures plan (ASCIA Action Plan), provided by the parent, that:
  - sets out the emergency procedures to be taken in the event of an allergic reaction;
  - is signed by a medical practitioner who was treating the child on the date the practitioner signs the emergency procedures plan; and
  - includes an up to date photograph of the student.

*Note: The red and blue 'ASCIA Action Plan' is the most common form of emergency procedures plan that is provided by medical practitioners to parents when a child is diagnosed as being at risk of anaphylaxis.*

- [Download from DEECD Health Support Planning Policy](#)

The student's individual management plan will be reviewed, in consultation with the student's parents/ carers:

- annually,
- if the student's condition changes, or
- immediately after a student has an anaphylactic reaction at school.

It is the responsibility of the parent to:

- provide the emergency procedures plan (ASCIA Action Plan).
- inform the school if their child's medical condition changes, and if relevant provide an updated emergency procedures plan (ASCIA Action Plan).
- provide an up to date photo for the emergency procedures plan (ASCIA Action Plan) when the plan is provided to the school and when it is reviewed.
- provide the College with an EpiPen that is 'in date' and update this as the EpiPen expires

#### **COMMUNICATION PLAN**

The Principal will be responsible for ensuring that a communication plan is developed to provide information to all staff, students and parents about anaphylaxis and the school's anaphylaxis management policy.

The communication plan will include information about what steps to take to respond to an anaphylactic reaction by a student in a classroom, in the school yard, on school excursions, on school camps and special event days.

Volunteers and casual relief staff of students at risk of anaphylaxis will be informed about students at risk of anaphylaxis and their role in responding to an anaphylactic reaction by student in their care by the Daily Organiser (CRT) or event organiser (volunteer).

All staff will be briefed once a semester by a staff member who has up to date anaphylaxis management training on:

- The school's anaphylaxis management policy
- The causes, symptoms and treatment of anaphylaxis
- Prevention strategies to minimise the risk of an anaphylactic reaction
- The identities of students diagnosed at risk of anaphylaxis and where their medication is located
- How to use an autoadrenaline injecting device
- The school's first aid and emergency response procedures

### *STAFF TRAINING AND EMERGENCY RESPONSE*

- All staff will be Anaphylaxis trained
- At the beginning of the school year, all staff will be attend a briefing outlining student health plans, including anaphylactic students and details of individual Anaphylaxis Management Plans and ASCIA Action plans
- Staff will undertake twice-yearly anaphylaxis briefings to ensure that they comply with DET anaphylaxis management under Ministerial Order 706: Anaphylaxis Management in Victorian Schools
- Teachers and other school staff who conduct classes which students at risk of anaphylaxis attend, or give instruction to students at risk of anaphylaxis must have up to date training in an anaphylaxis management course.
- At other times while the student is under the care or supervision of the school, including excursions, yard duty, camps and special event days, the principal must ensure that there is a sufficient number of staff present who have up to date training in an anaphylaxis management training course.
- The principal will identify the school staff to be trained based on a risk assessment.
- Wherever possible training of staff will take place before the student's first day of attendance
- In the event of an anaphylactic reaction, the Monbulk College's First Aid and Emergency Management response procedures and the student's Individual Anaphylaxis Management Plan will be followed

The College maintains supply of 'back up' Adrenaline Auto-injectors as part of the first aid kits and for general use through the College's First Aid procedures.

### **References:**

- Ministerial Order 706: Anaphylaxis Management in Victorian Schools  
[http://www.education.vic.gov.au/Documents/school/teachers/health/Anaphylaxis\\_MinisterialOrder706.pdf](http://www.education.vic.gov.au/Documents/school/teachers/health/Anaphylaxis_MinisterialOrder706.pdf)
- <http://www.education.vic.gov.au/school/principals/spag/health/pages/anaphylaxis.aspx>
- <http://www.education.vic.gov.au/school/principals/spag/health/Pages/supportplanning.aspx>
- <http://www.education.vic.gov.au/school/teachers/health/Pages/anaphylaxisschl.aspx>
- ASCIA – Anaphylaxis Resources  
<http://www.allergy.org.au/health-professionals/anaphylaxis-resources>
- DET 2014 Anaphylaxis Guidelines

### **Appendices:**

1. Anaphylaxis Management Plan
2. Anaphylaxis Risk Checklist

<b>Approved By</b>	School Council
<b>Approval Authority (Signature &amp; Date)</b>	<i>M J Uren</i> 25/5/16
<b>Responsible for Review</b>	Assistant Principal – Policy and Planning Sub-Committee
<b>Next Review Date</b>	February 2017

**Appendix 1**

## Individual Anaphylaxis Management Plan

This plan is to be completed by the principal or nominee on the basis of information from the student's medical practitioner (ASCIA Action Plan for Anaphylaxis) provided by the parent.

It is the parents' responsibility to provide the school with a copy of the student's ASCIA Action Plan for Anaphylaxis containing the emergency procedures plan (signed by the student's medical practitioner) and an up-to-date photo of the student - to be appended to this plan; and to inform the school if their child's medical condition changes.

<b>School</b>		<b>Phone</b>	
<b>Student</b>			
<b>DOB</b>		<b>Year level</b>	
<b>Severely allergic to:</b>			
<b>Other health conditions</b>			
<b>Medication at school</b>			
<b>EMERGENCY CONTACT DETAILS (PARENT)</b>			
<b>Name</b>		<b>Name</b>	
<b>Relationship</b>		<b>Relationship</b>	
<b>Home phone</b>		<b>Home phone</b>	
<b>Work phone</b>		<b>Work phone</b>	
<b>Mobile</b>		<b>Mobile</b>	
<b>Address</b>		<b>Address</b>	
<b>EMERGENCY CONTACT DETAILS (ALTERNATE)</b>			
<b>Name</b>		<b>Name</b>	
<b>Relationship</b>		<b>Relationship</b>	
<b>Home phone</b>		<b>Home phone</b>	
<b>Work phone</b>		<b>Work phone</b>	
<b>Mobile</b>		<b>Mobile</b>	
<b>Address</b>		<b>Address</b>	
<b>Medical practitioner contact</b>	<b>Name</b>		
	<b>Phone</b>		
<b>Emergency care to be provided at school</b>			
<b>Storage for adrenaline autoinjector (device specific) (EpiPen®)</b>			

## ENVIRONMENT

To be completed by principal or nominee. Please consider each environment/area (on and off school site) the student will be in for the year, e.g. classroom, canteen, food tech room, sports oval, excursions and camps etc.

**Name of environment/area:**

Risk identified	Actions required to minimise the risk	Who is responsible?	Completion date?

**Name of environment/area:**

Risk identified	Actions required to minimise the risk	Who is responsible?	Completion date?

**Name of environment/area:**

Risk identified	Actions required to minimise the risk	Who is responsible?	Completion date?

**Name of environment/area:**

Risk identified	Actions required to minimise the risk	Who is responsible?	Completion date?

**Name of environment/area:**

Risk identified	Actions required to minimise the risk	Who is responsible?	Completion date?

Name: \_\_\_\_\_  
Date of birth: \_\_\_\_\_

For use with EpiPen® adrenaline autoinjectors



Confirmed allergens: \_\_\_\_\_

Family/emergency contact name(s): \_\_\_\_\_

Work Ph: \_\_\_\_\_

Home Ph: \_\_\_\_\_

Mobile Ph: \_\_\_\_\_

Plan prepared by: \_\_\_\_\_

Dr: \_\_\_\_\_

I hereby authorise medications specified on this plan to be administered according to the plan.

Signed: \_\_\_\_\_

Date: \_\_\_\_\_

Date of next review: \_\_\_\_\_

## How to give EpiPen®



Form fist around EpiPen® and PULL OFF BLUE SAFETY RELEASE.



PLACE ORANGE END against outer mid-thigh (with or without clothing).

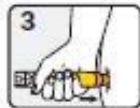

PUSH DOWN HARD until a click is heard or felt and hold in place for 10 seconds.

REMOVE EpiPen®. Massage injection site for 10 seconds.

Instructions are also on the device label and at: [www.allergy.org.au/anaphylaxis](http://www.allergy.org.au/anaphylaxis)

## MILD TO MODERATE ALLERGIC REACTION

- Swelling of lips, face, eyes
- Hives or welts
- Tingling mouth
- Abdominal pain, vomiting (these are signs of anaphylaxis for insect allergy)

## ACTION FOR MILD TO MODERATE ALLERGIC REACTION

- For insect allergy, flick out sting if visible. Do not remove ticks.
- Stay with person and call for help.
- Locate EpiPen® or EpiPen® Jr adrenaline autoinjector.
- Give other medications (if prescribed) \_\_\_\_\_
- Phone family/emergency contact.

**Mild to moderate allergic reactions may not always occur before anaphylaxis**

Watch for **ANY ONE** of the following signs of anaphylaxis

## ANAPHYLAXIS (SEVERE ALLERGIC REACTION)

- Difficult/noisy breathing
- Swelling of tongue
- Swelling/tightness in throat
- Difficulty talking and/or hoarse voice
- Wheeze or persistent cough
- Persistent dizziness or collapse
- Pale and floppy (young children)

## ACTION FOR ANAPHYLAXIS

- 1 Lay person flat. Do not allow them to stand or walk. If breathing is difficult allow them to sit.
- 2 Give EpiPen® or EpiPen® Jr adrenaline autoinjector.
- 3 Phone ambulance\*: 000 (AU) or 111 (NZ).
- 4 Phone family/emergency contact.
- 5 Further adrenaline doses may be given if no response after 5 minutes, if another adrenaline autoinjector is available.

### If in doubt, give adrenaline autoinjector

Commence CPR at any time if person is unresponsive and not breathing normally.

EpiPen® is generally prescribed for adults and children over 5 years.  
EpiPen® Jr is generally prescribed for children aged 1-5 years.

\*Medical observation in hospital for at least 4 hours is recommended after anaphylaxis.

### IF UNCERTAIN WHETHER IT IS ANAPHYLAXIS OR ASTHMA

- Give adrenaline autoinjector FIRST, then asthma reliever.
- If someone with known food or insect allergy suddenly develops severe asthma like symptoms, give adrenaline autoinjector FIRST, then asthma reliever.

Asthma: Y  N  Medication: \_\_\_\_\_

<p>This Individual Anaphylaxis Management Plan will be reviewed on any of the following occurrences (whichever happen earlier):</p> <p>annually</p> <p>if the student's medical condition, insofar as it relates to allergy and the potential for anaphylactic reaction, changes</p> <p>as soon as practicable after the student has an anaphylactic reaction at school</p> <p>when the student is to participate in an off-site activity, such as camps and excursions, or at special events conducted, organised or attended by the school (eg. class parties, elective subjects, cultural days, fetes, incursions).</p> <p>I have been consulted in the development of this Individual Anaphylaxis Management Plan.</p> <p>I consent to the risk minimisation strategies proposed.</p> <p>Risk minimisation strategies are available at Chapter 8 - Prevention Strategies of the Anaphylaxis Guidelines</p>	
Signature of parent:	
Date:	
<p>I have consulted the parents of the students and the relevant school staff who will be involved in the implementation of this Individual Anaphylaxis Management Plan.</p>	
Signature of principal (or nominee):	
Date:	



# Annual Risk Management Checklist

School Name:	
Date of Review:	
Who completed this checklist?	Name:
	Position:
Review given to:	Name
	Position
Comments:	

**General Information**

1. How many current students have been diagnosed as being at risk of anaphylaxis, and have been prescribed an Adrenaline Autoinjector?	
2. How many of these students carry their Adrenaline Autoinjector on their person?	
3. Have any students ever had an allergic reaction requiring medical intervention at school?	<input type="checkbox"/> Yes <input type="checkbox"/> No
a. If Yes, how many times?	
4. Have any students ever had an Anaphylactic Reaction at school?	<input type="checkbox"/> Yes <input type="checkbox"/> No
a. If Yes, how many students?	
b. If Yes, how many times	
5. Has a staff member been required to administer an Adrenaline Autoinjector to a student?	<input type="checkbox"/> Yes <input type="checkbox"/> No
a. If Yes, how many times?	
6. Was every incident in which a student suffered an anaphylactic reaction reported via the Incident Reporting and Information System (IRIS)?	<input type="checkbox"/> Yes <input type="checkbox"/> No

**SECTION 1: Individual Anaphylaxis Management Plans**

7. Does every student who has been diagnosed as being at risk of anaphylaxis and prescribed an Adrenaline Autoinjector have an Individual Anaphylaxis Management Plan and ASCIA Action Plan completed and signed by a prescribed Medical Practitioner?	<input type="checkbox"/> Yes <input type="checkbox"/> No
--	--



8. Are all Individual Anaphylaxis Management Plans reviewed regularly with Parents (at least annually)?	<input type="checkbox"/> Yes <input type="checkbox"/> No
9. Do the Individual Anaphylaxis Management Plans set out strategies to minimise the risk of exposure to allergens for the following in-school and out of class settings?	
a. During classroom activities, including elective classes	<input type="checkbox"/> Yes <input type="checkbox"/> No
b. In canteens or during lunch or snack times	<input type="checkbox"/> Yes <input type="checkbox"/> No
c. Before and after School, in the school yard and during breaks	<input type="checkbox"/> Yes <input type="checkbox"/> No
d. For special events, such as sports days, class parties and extra-curricular activities	<input type="checkbox"/> Yes <input type="checkbox"/> No
e. For excursions and camps	<input type="checkbox"/> Yes <input type="checkbox"/> No
f. Other	<input type="checkbox"/> Yes <input type="checkbox"/> No
10. Do all students who carry an Adrenaline Autoinjector on their person have a copy of their ASCIA Action Plan kept at the School (provided by the Parent)?	<input type="checkbox"/> Yes <input type="checkbox"/> No
a. Where are they kept?	
11. Does the ASCIA Action Plan include a recent photo of the student?	<input type="checkbox"/> Yes <input type="checkbox"/> No
<b>SECTION 2: Storage and Accessibility of Adrenaline Autoinjectors</b>	
12. Where are the student(s) Adrenaline Autoinjectors stored?	
13. Do all School Staff know where the School's Adrenaline Autoinjectors for General Use are stored?	<input type="checkbox"/> Yes <input type="checkbox"/> No
14. Are the Adrenaline Autoinjectors stored at room temperature (not refrigerated)?	<input type="checkbox"/> Yes <input type="checkbox"/> No
15. Is the storage safe?	<input type="checkbox"/> Yes <input type="checkbox"/> No
16. Is the storage unlocked and accessible to School Staff at all times?	<input type="checkbox"/> Yes <input type="checkbox"/> No
Comments:	

17. Are the Adrenaline Autoinjectors easy to find? Comments:	<input type="checkbox"/> Yes <input type="checkbox"/> No
18. Is a copy of student's Individual Anaphylaxis Management Plan (including the ASCIA Action Plan) kept together with the student's Adrenaline Autoinjector?	<input type="checkbox"/> Yes <input type="checkbox"/> No
19. Are the Adrenaline Autoinjectors and Individual Anaphylaxis Management Plans (including the ASCIA Action Plans) clearly labelled with the student's names?	<input type="checkbox"/> Yes <input type="checkbox"/> No
20. Has someone been designated to check the Adrenaline Autoinjector expiry dates on a regular basis? Who? .....	<input type="checkbox"/> Yes <input type="checkbox"/> No
21. Are there Adrenaline Autoinjectors which are currently in the possession of the School and which have expired?	<input type="checkbox"/> Yes <input type="checkbox"/> No
22. Has the School signed up to EpiClub or ANA-alert (optional free reminder services)?	<input type="checkbox"/> Yes <input type="checkbox"/> No
23. Do all School Staff know where the Adrenaline Autoinjectors and the Individual Anaphylaxis Management Plans are stored?	<input type="checkbox"/> Yes <input type="checkbox"/> No
24. Has the School purchased Adrenaline Autoinjector(s) for General Use, and have they been placed in the School's first aid kit(s)?	<input type="checkbox"/> Yes <input type="checkbox"/> No
25. Where are these first aid kits located?	
26. Is the Adrenaline Autoinjector for General Use clearly labelled as the 'General Use' Adrenaline Autoinjector?	<input type="checkbox"/> Yes <input type="checkbox"/> No
27. Is there a register for signing Adrenaline Autoinjectors in and out when taken for excursions, camps etc?	<input type="checkbox"/> Yes <input type="checkbox"/> No
<b>SECTION 3: Prevention Strategies</b>	
28. Have you done a risk assessment to identify potential accidental exposure to allergens for all students who have been diagnosed as being at risk of anaphylaxis?	<input type="checkbox"/> Yes <input type="checkbox"/> No
29. Have you implemented any of the prevention strategies in the Anaphylaxis Guidelines? If not record why?	<input type="checkbox"/> Yes <input type="checkbox"/> No
30. Have all School Staff who conduct classes with students with a medical condition that relates to allergy and the potential for anaphylactic reaction successfully completed an Anaphylaxis Management Training Course in the three years prior and participated in a twice yearly briefing?	<input type="checkbox"/> Yes <input type="checkbox"/> No
31. Are there always sufficient School Staff members on yard duty who have successfully completed an Anaphylaxis Management Training Course in the three years prior?	<input type="checkbox"/> Yes <input type="checkbox"/> No

**SECTION 4: School Management and Emergency Response**

32. Does the School have procedures for emergency responses to anaphylactic reactions? Are they clearly documented and communicated to all staff?	<input type="checkbox"/> Yes <input type="checkbox"/> No
33. Do School Staff know when their training needs to be renewed?	<input type="checkbox"/> Yes <input type="checkbox"/> No
34. Have you developed Emergency Response Procedures for when an allergic reaction occurs?	<input type="checkbox"/> Yes <input type="checkbox"/> No
a. In the class room?	<input type="checkbox"/> Yes <input type="checkbox"/> No
b. In the school yard?	<input type="checkbox"/> Yes <input type="checkbox"/> No
c. In all School buildings and sites, including gymnasiums and halls?	<input type="checkbox"/> Yes <input type="checkbox"/> No
d. At school camps and excursions?	<input type="checkbox"/> Yes <input type="checkbox"/> No
e. On special event days (such as sports days) conducted, organised or attended by the School?	<input type="checkbox"/> Yes <input type="checkbox"/> No
35. Does your plan include who will call the Ambulance?	<input type="checkbox"/> Yes <input type="checkbox"/> No
36. Is there a designated person who will be sent to collect the student's Adrenaline Autoinjector and Individual Anaphylaxis Management Plan (including the ASCIA Action Plan)?	<input type="checkbox"/> Yes <input type="checkbox"/> No
37. Have you checked how long it will take to get to the Adrenaline Autoinjector and Individual Anaphylaxis Management Plan (including the ASCIA Action Plan) to a student from various areas of the School including:	<input type="checkbox"/> Yes <input type="checkbox"/> No
a. The class room?	<input type="checkbox"/> Yes <input type="checkbox"/> No
b. The school yard?	<input type="checkbox"/> Yes <input type="checkbox"/> No
c. The sports field?	<input type="checkbox"/> Yes <input type="checkbox"/> No
38. On excursions or other out of school events is there a plan for who is responsible for ensuring the Adrenaline Autoinjector(s) and Individual Anaphylaxis Management Plans (including the ASCIA Action Plan) and the Adrenaline Autoinjector for General Use are correctly stored and available for use?	<input type="checkbox"/> Yes <input type="checkbox"/> No
39. Who will make these arrangements during excursions? .....	
40. Who will make these arrangements during camps? .....	
41. Who will make these arrangements during sporting activities? .....	
42. Is there a process for post incident support in place?	<input type="checkbox"/> Yes <input type="checkbox"/> No

43. Have all School Staff who conduct classes that students with a medical condition that relates to allergy and the potential for an anaphylactic reaction and any other staff identified by the Principal, been briefed on:	
a. The School's Anaphylaxis Management Policy?	<input type="checkbox"/> Yes <input type="checkbox"/> No
b. The causes, symptoms and treatment of anaphylaxis?	<input type="checkbox"/> Yes <input type="checkbox"/> No
c. The identities of students with a medical condition that relates to allergy and the potential for an anaphylactic reaction, and who are prescribed an Adrenaline Autoinjector, including where their medication is located?	<input type="checkbox"/> Yes <input type="checkbox"/> No
d. How to use an Adrenaline Autoinjector, including hands on practise with a trainer Adrenaline Autoinjector?	<input type="checkbox"/> Yes <input type="checkbox"/> No
e. The School's general first aid and emergency response procedures for all in-school and out-of-school environments?	<input type="checkbox"/> Yes <input type="checkbox"/> No
f. Where the Adrenaline Autoinjector(s) for General Use is kept?	<input type="checkbox"/> Yes <input type="checkbox"/> No
g. Where the Adrenaline Autoinjectors for individual students are located including if they carry it on their person?	<input type="checkbox"/> Yes <input type="checkbox"/> No
<b>SECTION 4: Communication Plan</b>	
44. Is there a Communication Plan in place to provide information about anaphylaxis and the School's policies?	
a. To School Staff?	<input type="checkbox"/> Yes <input type="checkbox"/> No
b. To students?	<input type="checkbox"/> Yes <input type="checkbox"/> No
c. To Parents?	<input type="checkbox"/> Yes <input type="checkbox"/> No
d. To volunteers?	<input type="checkbox"/> Yes <input type="checkbox"/> No
e. To casual relief staff?	<input type="checkbox"/> Yes <input type="checkbox"/> No
45. Is there a process for distributing this information to the relevant School Staff?	<input type="checkbox"/> Yes <input type="checkbox"/> No
a. What is it?	
46. How is this information kept up to date?	
47. Are there strategies in place to increase awareness about severe allergies among students for all in-school and out-of-school environments?	<input type="checkbox"/> Yes <input type="checkbox"/> No
48. What are they?	